



2.0 to 8.0GHz Coaxial Isolator

TG6237AS SMA Type

Outline Drawing (mm):



Features:

- ◇ Good temperature stability
- ◇ Withstand high power
- ◇ RoHS compliant
- ◇ Weight : ≈ 260 g

Material list:

- ◇ Cavity: aluminum conductive oxidation
- ◇ Outer shell: industrial pure iron nickel plating
- ◇ Guide body: Silver plated brass

Application:

- ◇ Rf amplifier final stage, protect the amplifier
- ◇ Digital communication
- ◇ Satellite communication
- ◇ Mobile communication

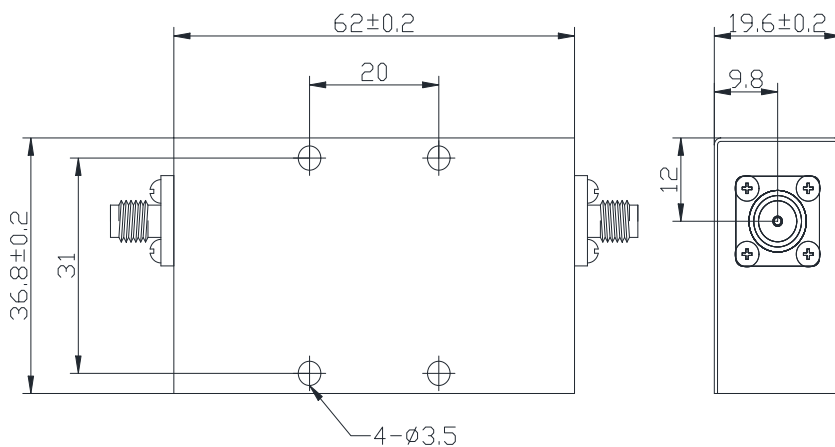

Order Examples:

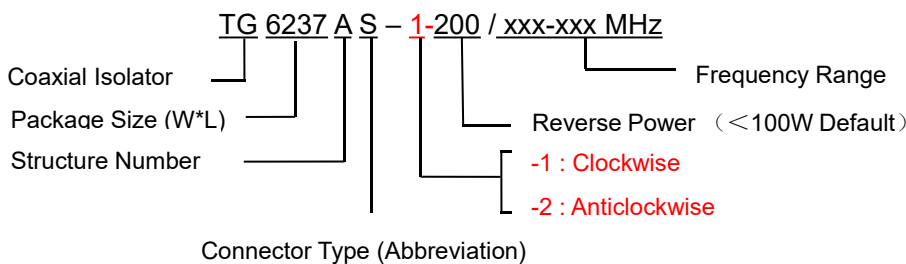

Connector Type:

SMA Type Connector Options			N Type Connector Options		
Port 1	Port 2	Abbreviation	Port 1	Port 2	Abbreviation
SMA-F	SMA-F	S	N-F	N-F	N
SMA-F	SMA-M	SKJ	N-F	N-M	NKJ
SMA-M	SMA-F	SJK	N-M	N-F	NJK
SMA-M	SMA-M	SJ	N-M	N-M	NJ

Basic Specifications:



Impedance	50 Ω
Connector Type	SMA-K
Size(mm)	62.0*36.8*19.6
Operating Temp	-10~+60℃
Storage temperature	-50~+90℃

Specifications:

Model No. (X=1: →Clockwise) (X=2: ←Anticlockwise)	Freq. Range GHz	IL. dB (max)	Isolation dB (min)	VSWR	Forward Power CW	Reverse Power W
TG6237AS-X/2.0-6.0GHz	2.0-6.0	1.20	15.0	1.50	20	10
TG6237AS-X/2.0-8.0GHz	2.0-8.0	1.70@2.0-2.02GHz	13.0	1.60	20	10
		1.50@2.02-8.0GHz				

Instructions:

- 1, The isolator connector can be selected SMA male and female head, can be used with the user;
- 2, Reflected power isolators only 10W choice, can not be customized;
- 3, Only some common frequencies in the table, can be produced according to the user's requirements;
- 4, If you do not find what you are looking for, please contact us!